

AREA OF REVISIONS		LOT AREAS	
FIRST REVISION		1 To 28 INCLUSIVE	144.0
153-157	72.0	29	147.96
158-159	144.0	30	133.72
160	108.0	31	144.0
SECOND REVISION		32-33 36-37 40-41 44-45	160.0
161-171	72	48-49 52-53 56-57 60-61	144.0
172	70.65	34-35 38-39 42-43 46-47	144.0
		50-51 54-55 58-59 62-63	171.0
		64-65	288.0
		66-68 70-72 74 76 78 80	320.0
		67 69 71 73 75 77 79 81	304.0
		82	143.65
		83	288.0
		84 86 88 90 92 94 96 98	320.0
		85 87 89 91 93 95 97	304.0
		99	151.37
		100	160.0
		101 104-105 108-109 112-113	144.0
		116-117 120-121 124-125 128-129	144.0
		102-103 106 107 110 111 114 115	130 144.0
		118 119 122 123 126 127	131 129.58
		132 To 152 INCLUSIVE	744.0

REGULATIONS FOR BLOCK "G"

On all lots, except monument lots, single and double headstones are permitted and shall be set 6" above ground level at the highest dimension, with 1" base and all surfaces finished. Single headstones shall be 2' by 1' and double headstones shall be 1' in width and not less than 3' or more than 4' in length.

Monuments may be erected only on such lots as are designated for this purpose, by the cemetery, and are to be set in lot centers. Sides and top of die shall be finished; rock ends only. Base may be rock faced. No monument shall exceed one-half the width of a 4 grave lot, or one-third third the width of an 8 grave lot. Single headstones may be used with monuments on an 8 grave lot, and shall be set on the front and rear lot lines, such lines to be so designated by the cemetery.

All memorials shall be of granite, shall be set not less than 2" below ground level and shall face the front lot line.

Landscaping will be permitted for monuments erected on 8 grave lots, subject to cemetery approval as to design and planting material. Planting shall be done by employees of the cemetery, or its designated contractors. No lot planting, other than that specified by the foregoing, will be permitted. Summer decorations, such as potted plants, are limited to one for each occupied grave, and shall be not more than 1' high and 1' in diameter. Cut flowers are permitted at any time.

No sod may be removed, except by authority of the cemetery.

The regulations herein contained shall supersede all previous regulations referring to Block "G", Evergreen Cemetery.

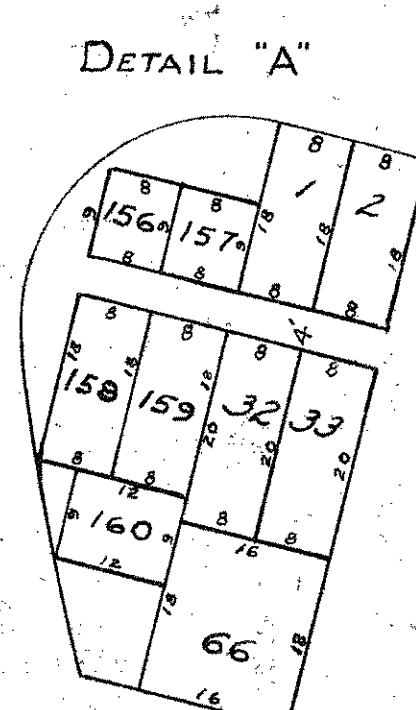
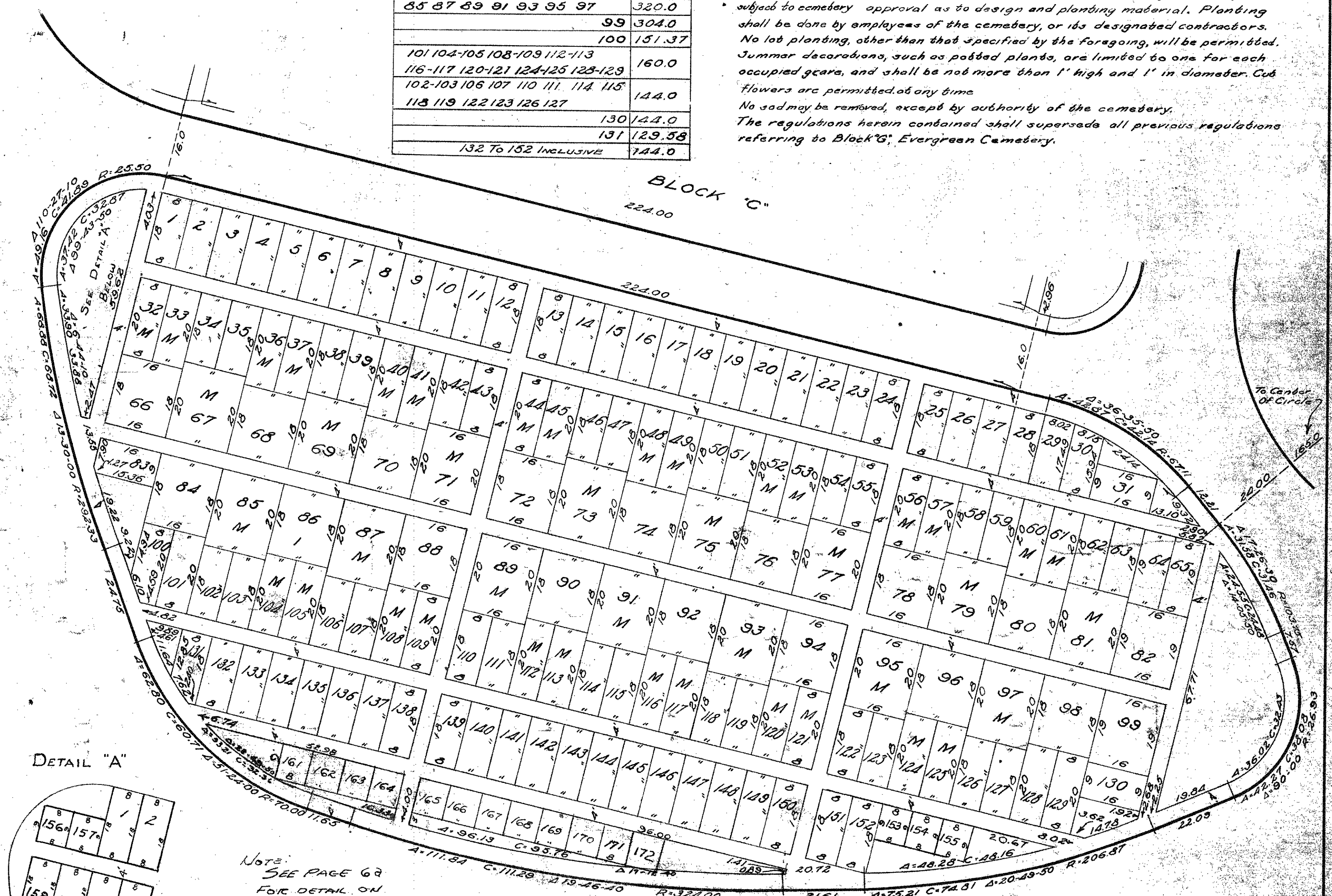

NOTE:
SEE PAGE 62
FOR DETAIL ON
LOTS 161 TO 171

APPROVED BY *[Signature]*
CITY MANAGER

FIRST REVISION APPROVED BY *[Signature]*

SECOND REVISION APPROVED BY *[Signature]*
CITY MANAGER

ORDINANCE NO. 2-61 (2-20-61)

BLOCK "G"
EVERGREEN CEMETERY
SCALE 1"=20'
MARCH, 1950