



# DIVISION 13

-  PROPOSED TREE
-  MONUMENT LOT
-  WALKWAY

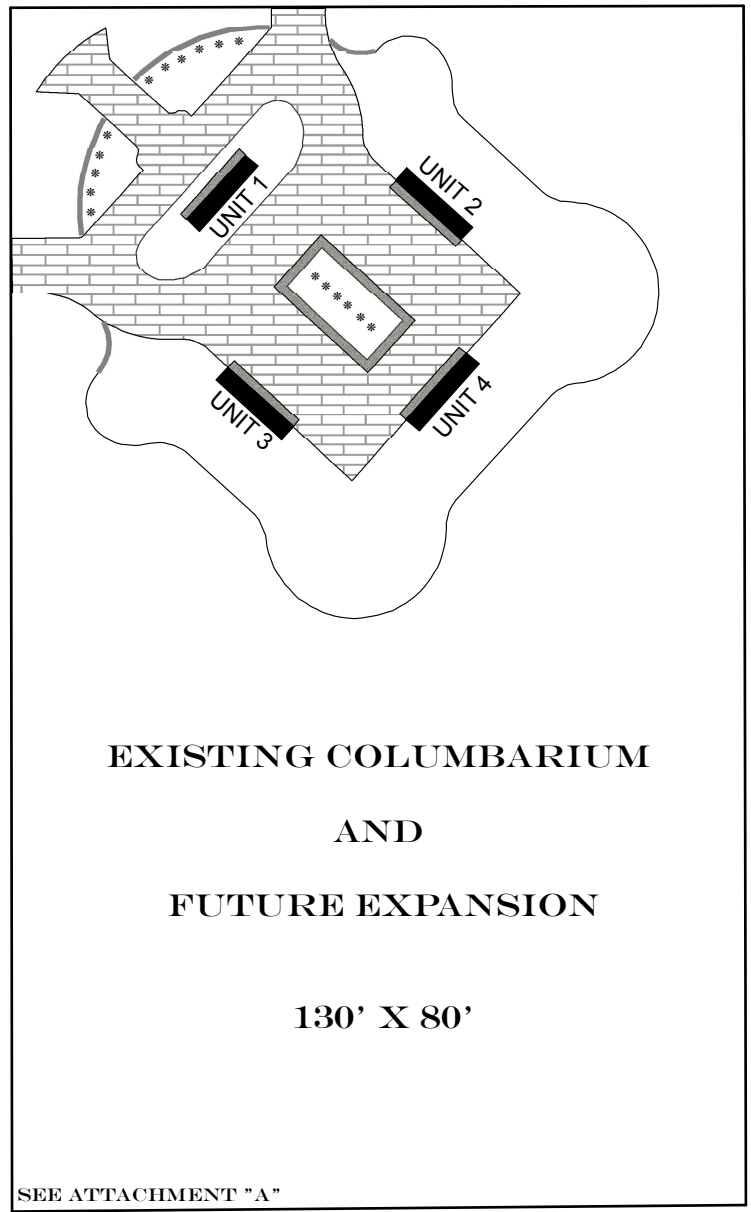

8' X 10' FULL BURIAL LOTS

|     |     |     |     |     |     |     |     |     |     |     |     |     |     |     |     |     |     |     |     |     |     |     |     |
|-----|-----|-----|-----|-----|-----|-----|-----|-----|-----|-----|-----|-----|-----|-----|-----|-----|-----|-----|-----|-----|-----|-----|-----|
| 408 | 407 | 406 | 405 | 404 | 403 | 402 | 401 | 400 | 399 | 398 | 397 | 396 | 395 | 394 | 393 | 392 | 391 | 390 | 389 | 388 | 387 | 386 | 385 |
| 432 | 431 | 430 | 429 | 428 | 427 | 426 | 425 | 424 | 423 | 422 | 421 | 420 | 419 | 418 | 417 | 416 | 415 | 414 | 413 | 412 | 411 | 410 | 409 |
| 456 | 455 | 454 | 453 | 452 | 451 | 450 | 449 | 448 | 447 | 446 | 445 | 444 | 443 | 442 | 441 | 440 | 439 | 438 | 437 | 436 | 435 | 434 | 433 |
| 480 | 479 | 478 | 477 | 476 | 475 | 474 | 473 | 472 | 471 | 470 | 469 | 468 | 467 | 466 | 465 | 464 | 463 | 462 | 461 | 460 | 459 | 458 | 457 |
| 504 | 503 | 502 | 501 | 500 | 499 | 498 | 497 | 496 | 495 | 494 | 493 | 492 | 491 | 490 | 489 | 488 | 487 | 486 | 485 | 484 | 483 | 482 | 481 |
| 528 | 527 | 526 | 525 | 524 | 523 | 522 | 521 | 520 | 519 | 518 | 517 | 516 | 515 | 514 | 513 | 512 | 511 | 510 | 509 | 508 | 507 | 506 | 505 |

4' X 5' CREMATION LOTS

|     |     |     |     |     |     |     |     |     |     |     |     |     |     |     |
|-----|-----|-----|-----|-----|-----|-----|-----|-----|-----|-----|-----|-----|-----|-----|
| 384 | 383 | 382 | 381 | 380 | 379 | 378 | 377 | 376 | 375 | 374 | 373 | 372 | 371 | 370 |
| 354 | 353 | 352 | 351 | 350 | 349 | 348 | 347 | 346 | 345 | 344 | 343 | 342 | 341 | 340 |
| 324 | 323 | 322 | 321 | 320 | 319 | 318 | 317 | 316 | 315 | 314 | 313 | 312 | 311 | 310 |
| 294 | 293 | 292 | 291 | 290 | 289 | 288 | 287 | 286 | 285 | 284 | 283 | 282 | 281 | 280 |
| 264 | 263 | 262 | 261 | 260 | 259 | 258 | 257 | 256 | 255 | 254 | 253 | 252 | 251 | 250 |
| 234 | 233 | 232 | 231 | 230 | 229 | 228 | 227 | 226 | 225 | 224 | 223 | 222 | 221 | 220 |
| 204 | 203 | 202 | 201 | 200 | 199 | 198 | 197 | 196 | 195 | 194 | 193 | 192 | 191 | 190 |
| 174 | 173 | 172 | 171 | 170 | 169 | 168 | 167 | 166 | 165 | 164 | 163 | 162 | 161 | 160 |

|     |     |     |     |     |     |     |     |     |     |     |     |     |     |     |     |     |     |     |     |     |     |     |     |
|-----|-----|-----|-----|-----|-----|-----|-----|-----|-----|-----|-----|-----|-----|-----|-----|-----|-----|-----|-----|-----|-----|-----|-----|
| 121 | 122 | 123 | 124 | 125 | 126 | 127 | 128 | 129 | 130 | 131 | 132 | 133 | 134 | 135 | 136 | 137 | 138 | 139 | 140 | 141 | 142 | 143 | 144 |
| 97  | 98  | 99  | 100 | 101 | 102 | 103 | 104 | 105 | 106 | 107 | 108 | 109 | 110 | 111 | 112 | 113 | 114 | 115 | 116 | 117 | 118 | 119 | 120 |
| 73  | 74  | 75  | 76  | 77  | 78  | 79  | 80  | 81  | 82  | 83  | 84  | 85  | 86  | 87  | 88  | 89  | 90  | 91  | 92  | 93  | 94  | 95  | 96  |
| 49  | 50  | 51  | 52  | 53  | 54  | 55  | 56  | 57  | 58  | 59  | 60  | 61  | 62  | 63  | 64  | 65  | 66  | 67  | 68  | 69  | 70  | 71  | 72  |
| 25  | 26  | 27  | 28  | 29  | 30  | 31  | 32  | 33  | 34  | 35  | 36  | 37  | 38  | 39  | 40  | 41  | 42  | 43  | 44  | 45  | 46  | 47  | 48  |
| 1   | 2   | 3   | 4   | 5   | 6   | 7   | 8   | 9   | 10  | 11  | 12  | 13  | 14  | 15  | 16  | 17  | 18  | 19  | 20  | 21  | 22  | 23  | 24  |

|     |     |     |     |     |     |     |     |     |     |     |     |     |     |     |
|-----|-----|-----|-----|-----|-----|-----|-----|-----|-----|-----|-----|-----|-----|-----|
| 369 | 368 | 367 | 366 | 365 | 364 | 363 | 362 | 361 | 360 | 359 | 358 | 357 | 356 | 355 |
| 339 | 338 | 337 | 336 | 335 | 334 | 333 | 332 | 331 | 330 | 329 | 328 | 327 | 326 | 325 |
| 309 | 308 | 307 | 306 | 305 | 304 | 303 | 302 | 301 | 300 | 299 | 298 | 297 | 296 | 295 |
| 279 | 278 | 277 | 276 | 275 | 274 | 273 | 272 | 271 | 270 | 269 | 268 | 267 | 266 | 265 |
| 249 | 248 | 247 | 246 | 245 | 244 | 243 | 242 | 241 | 240 | 239 | 238 | 237 | 236 | 235 |
| 219 | 218 | 217 | 216 | 215 | 214 | 213 | 212 | 211 | 210 | 209 | 208 | 207 | 206 | 205 |
| 189 | 188 | 187 | 186 | 185 | 184 | 183 | 182 | 181 | 180 | 179 | 178 | 177 | 176 | 175 |
| 159 | 158 | 157 | 156 | 155 | 154 | 153 | 152 | 151 | 150 | 149 | 148 | 147 | 146 | 145 |

332'

RECREATION & PUBLIC LANDS DIRECTOR

CITY ENGINEER

CITY MANAGER

APPROVED THIS \_\_\_\_ DAY OF \_\_\_\_\_ 2009

APPROVED THIS \_\_\_\_ DAY OF \_\_\_\_\_ 2009

APPROVED THIS \_\_\_\_ DAY OF \_\_\_\_\_ 2009